



TOP GUN TITAN FLIP STEALTH OPERATORS MANUAL



! WARNING !

Auto-Darkening welding helmet is designed to protect the welders' eyes from harmful radiation including visible light, ultraviolet radiation (UV) and infra-red radiation (IR) resulting from certain arc and gas welding processes when used in accordance with user instructions.

Ensure that helmet comes properly assembled. However, before it can be used, it must be adjusted to your personal preferences. Set it up for delay time, sensitivity, and shade number for your application. (See the table with recommended shade levels)

PRECAUTIONS

- Never place the helmet or the ADF on hot surface.
- Use only at temperature: -5°C to +55°C (23°F-131°F).
- Do not immerse the filter in water, and protect it from contact with liquid and dirt.
- The material which may contact with the wearer's skin can cause allergic reaction. Any welding helmet worn over standard ophthalmic spectacles may transmit impact, thus creating a hazard to the wearers in some circumstances.
- This product cannot be used for overhead welding or cutting. If this product is used for overhead welding or cutting operation, the molten metal drop may burn through helmet and welder will get injured.
- Eye protector shall only be used against high-speed particles at room temperature.
- Automatic welding filter shall always be used with a backing ocular.
- Unauthorized modifications and replacement parts will void the warranty and expose the operator to the risk of personal injury.
- Some Auto-Darkening welding helmet is not suitable for laser welding or welding process that require shade 14 or higher shade.
- If the auto-darkening filter do not darken when the arc ignites, stop welding immediately and inspect the ADF and its power supply. Change if necessary.
- Do not use any solvents or abrasive cleaning detergent on the filter screen or helmet components.
- We recommend a usage period of 4 years. The period depends on various factors such as way of use, cleaning, storage, and maintenance. Frequent inspections and replacement in case of damage are recommended.
- Always wear safety glasses or goggles under the welding helmet and protection clothing to protect your skin from radiation, burns and spatter.
- Not suitable for driving and road use

► WELDING HELMET MANUAL

- Protectors that have been subject to impact shall not be used and shall be discarded and replaced.
- If the impact level symbols are not equal on both the lens/filter and the frame, then it is the lower level that shall be assigned to the complete protector.
- The protection marked in accordance with this standard is only provided when all lens and retention components are installed according to the list or other manufacturer's instructions.
- This device does not protect against physical or chemical hazards.
If the helmet, or the filter or the cover plate is in any way damaged, they must be immediately replaced.
- Replace the device after a mechanical impact.
- A visual inspection is necessary before every use.

STORAGE

When not in use the filter should be stored in a dry place within the temperature range of -20°C to $+70^{\circ}\text{C}$. Prolonged exposure to temperatures above 45°C may decrease the battery.

It is recommended to keep the solar cells of the auto darkening welding filter in the dark or not exposed to light during storage in order to maintain power down mode. This can be achieved by simply placing the filter face down on the storage shelf.

Welding helmet should not be dropped and do not place any heavy items or tools on or inside the helmet, which may damage the electro-optical filter.

MAINTENANCE & CLEANING&TRANSPORTING

It is always necessary to keep the solar cells and the light sensors of the welding filter free of dust and spatters. Cleaning can be done with a soft tissue or cloth soaked in mild detergent (or alcohol). Never use aggressive solvents such as acetone.

The user must make daily regular checks to ensure no damage is evident. Outer and inner visors are worn parts and must be replaced regularly with genuine certified universal spare parts.

Transport the equipment with original packing box and away from direct sunlight .

OPERATING INSTRUCTION

Before Using

- Make sure to remove any additional protection foil from both sides of the PC lens.
- Make sure there is no dust on any sensor.
- Set the exact mode that you need.

► WELDING HELMET MANUAL

Testing Function

Long-press the **Mode** button with **1.0s**, the ADF will turn dark.(See Fig.14&Fig.15).

SET THE MODES

The ADF got **4 MODES**, press **MODE** button, selecting the function as you need. Kindly check below ,and Fig.14&Fig.15.

	GRIND shade 3	CUT shade (4-8)	WELD shade (4-8)	WELD shade (9-13)	WELD shade (9-14)
P20 Series P21 Series	√	√	√	√	×
P31 Series	√	√	√	√	×
P33 Series	√	√	√		√

There is an easy way for some model, long-press (1.0s) outside **GRIND** button on the helmet shell like Fig.13, it can switch to **GRIND** mode.

X2 model offering side-windows with shade 5.(See Fig.6).

F1 mode offering a big grinding view. (See Fig.10)

Warning: Do not weld in **GRIND** or **CUT** mode.

Some ADF got 3 advanced functions, check below.(See Fig.15).

	Automatic Shade Adjust	Automatic Sensitivity Adjust	Automatic Delay Adjust
P20 Series P21 Series	×	×	×
P31 Series	√,At Weld Mode	√,At Weld Mode	√,At Weld Mode
P33 Series	√,At Weld Mode	√,At Weld Mode	√,At Weld Mode

Check the operating panel in Fig.15, long-press the relative button with 1.0 s, the function will go automatic.In automatic shade mode, the ADF can adjust the shade number automatically from - 2 to +2.

	SHADE	SENSI (Sensitivity)	DELAY	GRADIENT
GRIND	Shade 3	Not Displayed	Not Displayed	No
CUT	Shade(4-8)	Not Displayed	Not Displayed	No
WELD	Shade(4-8) Shade (9-13) Shade (9-14)	(0-9)10 Levels For Adjustment	0-9(0.04-2.0S)10 Levels For Adjustment	Optional

▶ WELDING HELMET MANUAL

Checking the operating panel (See Fig.14&Fig.15).press FUNC.and UP&DOWN button.Or press SENS/DELAY and UP/DOWN button.

For SENSITIVITY

Level of 9(SUPER)-Most for welding applications but specially for low current welding work.

Level of 0 -Only in some specific surrounding lighting conditions in order to avoid unwanted triggering.

For DELAY

The recovery time intervals are recommended extended when the shade increases.

Level 9:Maximum delay time is 2.0s. it is suitable for most welding application, especially for high amperage current application and longer welding interval.

Level 0:Minimum delay time is 0.04s. It is suitable for spot weld.

GRADIENT Mode

Checking the operating panel(Fig.14&Fig.15) long-press FUNC. or GRADIENT button,it will be started.

GRADIENT mode allows shade gradually return from dark to light, and make welders' eyes more comfortable.

NOTE: The operating of **UP** and **DOWN**, 1 press of **UP/DOWN** button, the relative function increase/decrease by 1.

MEMORY MODE

Checking the operating panel,using MEMORY and UP/DOWN buttons.(See Fig.14&Fig.15).

Archive Setting (M/W X) W:Writing



Extract Record (M/R X) R:Read



POWER

If the battery icon is flashing, please change the battery, otherwise the operation will not perform well.

NOTE: After changing the battery, you need to self-check the ADF by long- press **MODE** button. It is essential to mount it in correct way as the illustration when replacing the battery.(The tray will depict the polarity showing which side is + and which side is negative.)(See Fig.12).

HELMET ADJUSTMENTS

HEADGEAR ASSEMBLY

Insert the headgear into helmet shell, as the installation order is in Fig1.

Adjust the headgear to make it more comfortable and put shield in the correct position according to individual preference(See Fig.2-Fig.5).

NOTE: Make sure both sides are equally positioned for proper operation.

REPLACING AUTO DARKENING WELDING FILTER

- 1.Remove the front protection plate and put the helmet face down, and press both taps in the top of the filter and push the ADF out(See Fig.7).
- 2.For FLIP-UP model, remove the front cover plate like Fig.10 and put helmet shell face down , then press both taps and push. ADF can be separated from the helmet shell.(See Fig.8).

REPLACING PROTECTION PLATES

- 1.If protection plates are in any way damaged, they must be immediately replaced (See Fig.9 &Fig.11).
- 2.For FLIP-UP welding helmet model,check the Fig.10&Fig.11.
Flip up the cover shell, twist two buckles, and change the inner grind cover plate.(See Fig.10).

BATTERY REPLACEMENT

Remove the ADF casstte. Pull out the battery stray, and correct battery operation as indicated on the battery stray(See Fig.12).

TROUBLE SHOOTING

● Irregular Darkening Dimming

Headgear has been set unevenly so there is an uneven distance from the eyes to the filter lens. (Reset the headband to reduce the difference to the filter).

● The Filter Does Not Darken or Flickers

- 1.Front cover lens is soiled or damaged (please change the cover lens);
- 2.Sensors are soiled/blocked or solar panel is blocked (Clean the sensors surface to make sure you are not blocking the sensors or solar panel with your arm or other obstacle while welding);
- 3.Sensitivity is set too low or delay time is set too short (Adjust to required level);
- 4.Make sure proper shade is selected (not Grind mode).

▶ WELDING HELMET MANUAL

- **The Filter Darkening Without Arc Being Struck**
Sensitivity is set too high (Adjust Sensitivity to a required level).
- **The Filter Remains Dark After Completing A Weld**
Delay time is set too long (Adjust Delay time to a required level).
- **Slow Response**
Operating temperature is too low (Do not use at temperatures below -10°C or 14°F).
- **Welding Helmet Slips**
Headgear is not properly adjusted. (Readjust the headband).

MARKING EXPLANATION

Auto Darkening Filter Marking

16321 YXE W3/4-8/9-13 V2

W3/4<8/9<14 M YXE V1

3=Light State Scale Number

M=Manual offset(optional)

4-8/9-13=Protection Shade Numbers in Dark State

CE=European Conformity

YXE= Manufacture Identification

V2=Angle of Dependence Classification

V1=Angle of Dependence Classification

UKCA=UK Conformity

Helmet Marking

16321 YXE W14 E 1-M CE UKCA

YXE EN 175 B CE UKCA

16321 = ISO Standard

YXE = Manufacturer's identification

YXE = Manufacturer's identification

EN 175 = EN Standard

W = Welding protector

B= Impact Resistance Level 120m/s

14 = Maximum filter shade number

CE = European Conformity

E= Impact Resistance Level 120m/s

UKCA = UK Conformity

1-M applicable head size

Cover Plate Marking

YXE 1 E CE YXE 1 E CE UKCA

YXE=Manufacturer's Identification

1 =Enhanced Optical Performance

E= Impact Level 120m/s

CE=European Conformity

UKCA = UK Conformity

D=Impact Level 80m/s

► WELDING HELMET MANUAL

SPECIFICATION DATA

Model	P20 series	P21 series	P31 series	P33 series
CE Classification	1/1/1/2	1/1/1/1		
Viewing Area	108*74mm(12.27in ²) 108*82mm(13.72in ²)Max Series			
Front Cover Plate	XD-PLC1(PC 178.6*129.9*1.5MM)			
ADF Light State	Shade 3			
Variable Shade	4-8/9-13			4-8/9-14
Sensitivity	0-9 levels			
Delay	0-9 levels(0.04-2.0s)			
Memory Mode	10 Records			
Sensor	4			
Power Supply	CR2450*2 Lithium Battery			
Operating Temp.	-5°C-55°C			
Inside Protection Plates	114*89*0.8mm			
Auto Function	No		Yes	

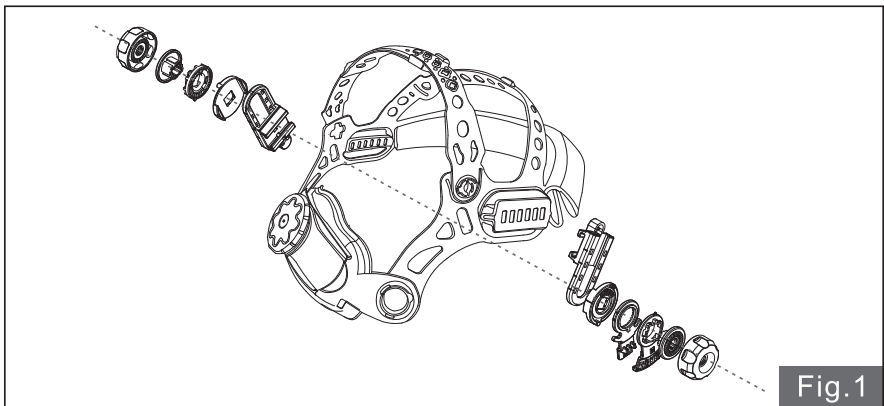
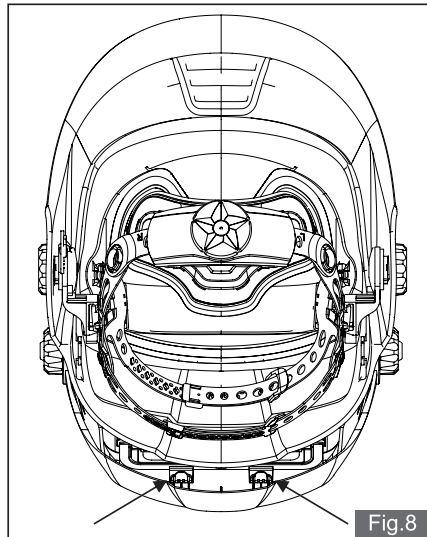
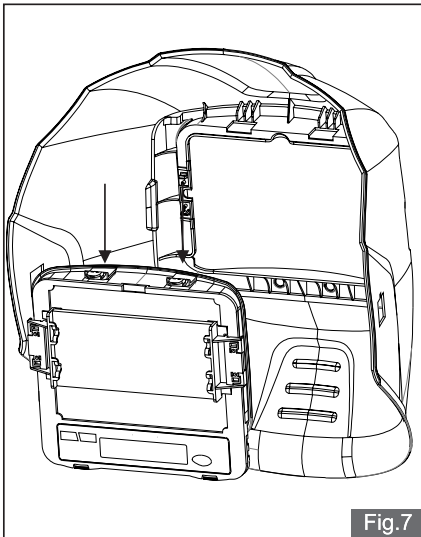
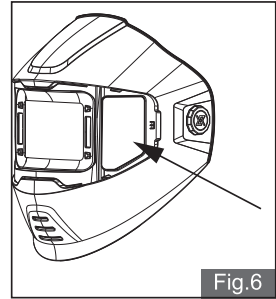
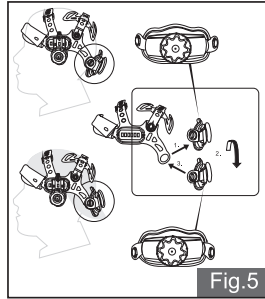
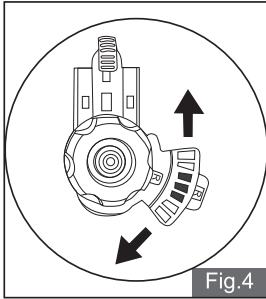
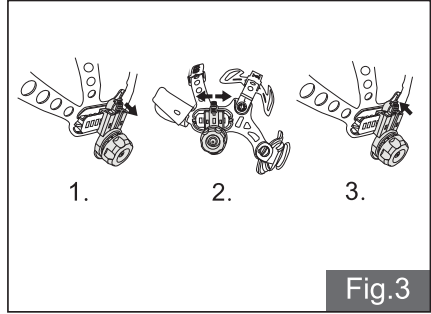
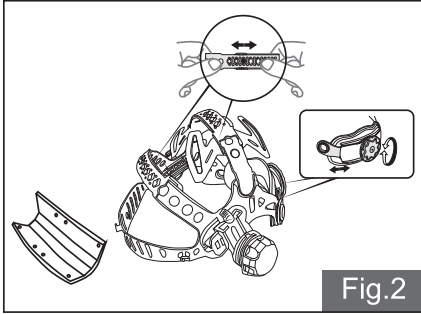
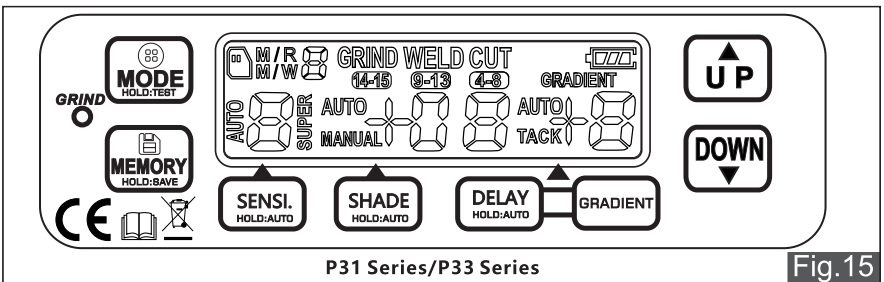
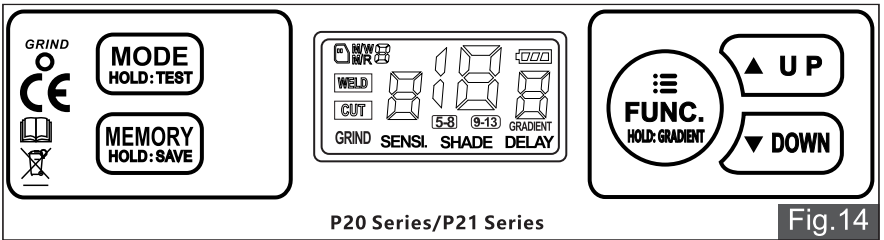
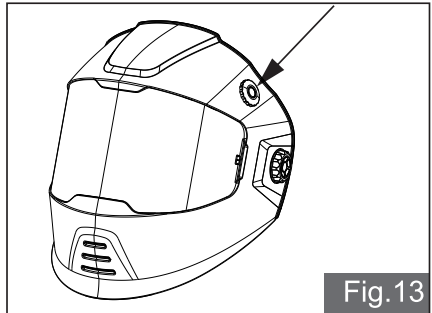
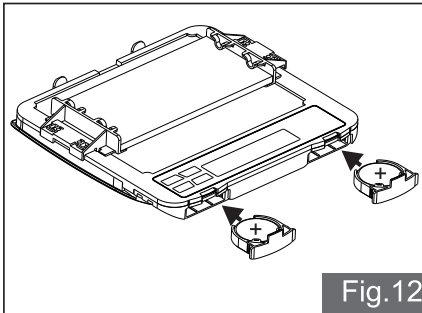
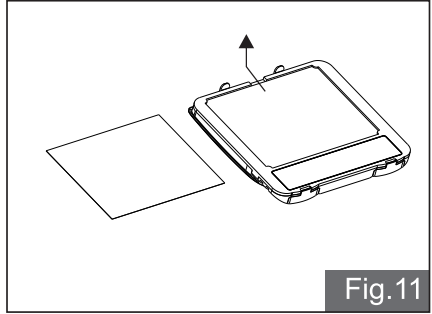
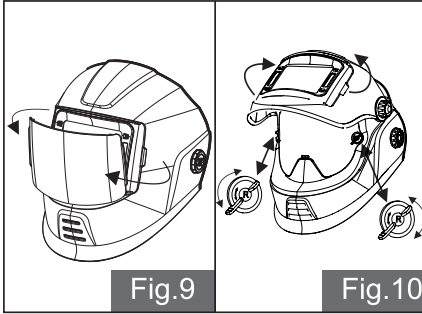

Fig.1

► WELDING HELMET MANUAL



► WELDING HELMET MANUAL



INSTALLATION SAMPLE

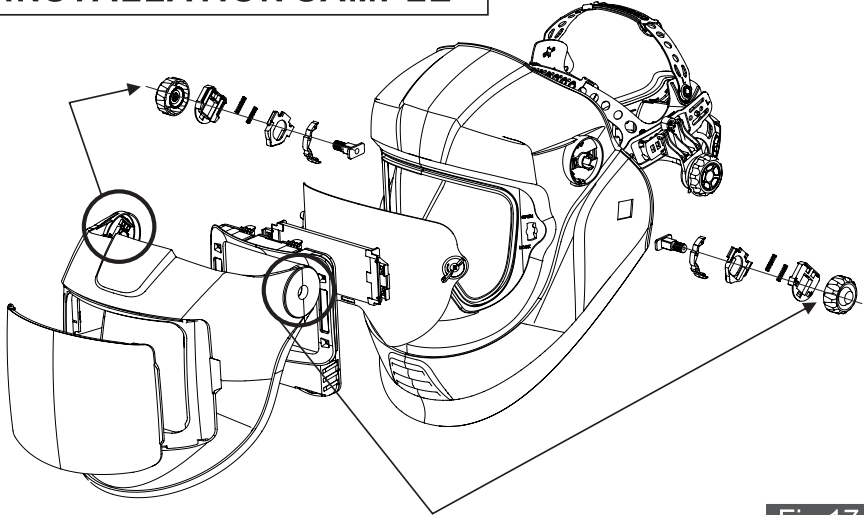

Fig.17

INSTALLATION SAMPLE

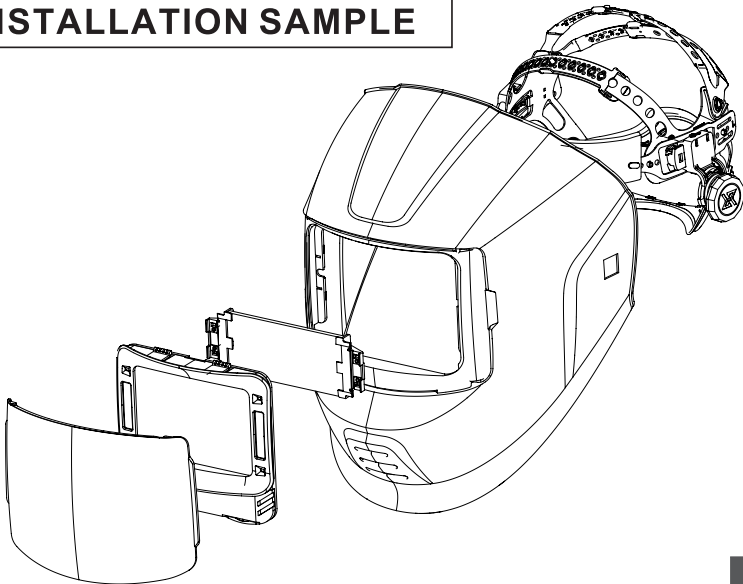

Fig.17



WWW.TOPGUNWELDING.COM.AU